

**Licensing Act 2003  
Schedule 12  
Part A**

Regulation 33,34

**Premises Licence**

Premises Licence Number

15/00518/LAPRE

**Part 1 – Premises Details**

**Postal address of premises, or if none, ordnance survey map reference or description, including Post Town, Post Code**

Woody Express  
103 The Parade  
High Street  
Watford  
WD17 1LU

**Telephone number**

**Where the licence is time limited the dates**

From 14 May 2015

**Licensable activities authorised by the licence and the times the licence authorises the carrying out of licensable activities**

Late night refreshment	Monday	23:00 – 03:00
	Tuesday, Wednesday, Thursday	23:00 – 01:00
	Friday, Saturday	23:00 – 03:15
	Sunday	23:00 – 00:00

**The opening hours of the premises**

Monday	11:00 – 03:00
Tuesday, Wednesday, Thursday	11:00 – 01:00
Friday, Saturday	11:00 – 03:15
Sunday	11:00 – 00:00

**Where the licence authorises supplies of alcohol whether these are on and / or off supplies**

Not applicable

Premises Licence page 1

G:\COMMITTEE REPORTS (Part A only)\Licensing Sub-Committee\2014-15\2015 05 14 - Woody Express\Draft Premises Licence.doc

**Part 2**

**Name, (registered) address, telephone number and email (where relevant) of holder of premises licence**

Mr Cengiz Erpolat  
103 The Parade  
High Street  
Watford  
WD17 1LU

**Registered number of holder, for example company number, charity number (where applicable)**

Not applicable

**Name, address and telephone number of designated premises supervisor where the premises licence authorises the supply of alcohol**

Not applicable

**Personal licence number and issuing authority of personal licence held by designated premises supervisor where the premises licence authorises for the supply of alcohol**

Personal Licence Number: Not applicable  
Licensing Authority: Not applicable

DRAFT

## **Annex 1 – Mandatory conditions**

1. Any individual employed on the premises to conduct a security activity (within the meaning of section paragraph 2(1)(a) of schedule 2 to the Private Security Industry Act 2001) must be licensed by the Security Industry Authority.

DRAFT

## **Annex 2 – Conditions consistent with the Operating Schedule**

**The following conditions are considered by officers to be consistent with the Operating Schedule submitted with this application, reference 15/00518/LAPRE:**

1. All doors and windows shall be kept closed except for the immediate access and egress of persons

DRAFT

### **Annex 3 – Conditions attached after a hearing by the licensing authority**

**The following condition has been proposed in response to representations regarding this application, and is based upon a condition suggested by the Police.**

1. There shall be at least 1 SIA licensed door supervisor on duty at the entrance of the premises from 23:00 on Monday, Friday and Saturday. The door supervisor shall remain on duty until 30 minutes after the premises closes to the public.

**The following conditions have been proposed in response to representations regarding this application, and are based upon conditions suggested by Environmental Health.**

2. All litter, including food debris, which is associated with the use of the premises shall be cleared from within a 15 metre radius of the shop front at the close of business every day. All such rubbish to be disposed of as trade waste.
3. All customers who order food to take-away after 23:00, shall be asked if they require a bag and serviettes for their food, and shall only be provided if required by the customer.
4. Notices shall be prominently displayed at all exits requesting patrons to respect the needs of local residents and leave the area quietly, and to dispose of their waste responsibly.
5. A bin shall be provided for public use within the public area of the premises.

**The inclusion of these conditions does not restrict the Sub-Committee's power to attach conditions from the licensing authority's pool of conditions (amended or otherwise) or to compose their own conditions if they consider that they are appropriate to promote the licensing objectives, proportionate, justifiable, and within the applicant's power to comply with.**

Annex 4 – Plans

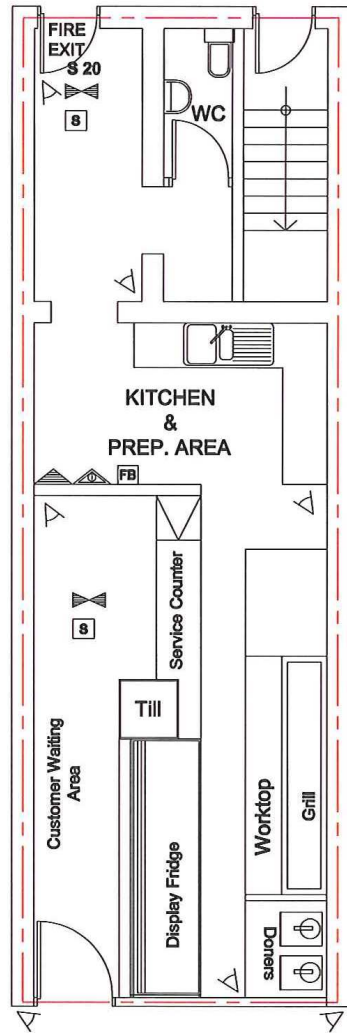

**LEGEND**

- WC AREA
- FRIDGE
- AMBIT OF LICENSED PREMISES
- SAFETY LIGHTS
- SMOKE DETECTOR
- CARBON DIOXIDE FIRE EXTINGUISHER
- 9 LT. WATER FIRE EXTINGUISHER
- FIRE ESCAPE KEEP CLEAR
- CCTV
- INTERNALLY ILLUMINATED FIRE ESCAPE SIGN (BS 5266)
- FIRE BLANKET
- FAN 6lt/s
- FIRE ALARM BELL
- FIRE DOOR
- FIRE SWITCH PANEL

THE PARADE  
HIGH STREET



*Alto*  
*Design & Build Ltd*  
ARCHITECTURAL & ENGINEERING DESIGN  
2 CHEAPSIDE, NORTH CIRCULAR ROAD  
LONDON, N13 5ED  
T: 0772 333 1891, 020 3213 0192  
e-mail: akosele@altogroup.co.uk  
www.altogroup.co.uk

PROJECT : Premises Licence Application  
DRAWING TITLE: Floor Plan  
PROJECT ADDRESS : 103-105 The Parade,  
High Street  
Hertford, WD17 1LU  
SCALE : 1:50 @ A4 DATE : Dec./2014  
PROJECT No : CE14-01